

# INDEPENDENT INNOVATIVE SOLUTIONS

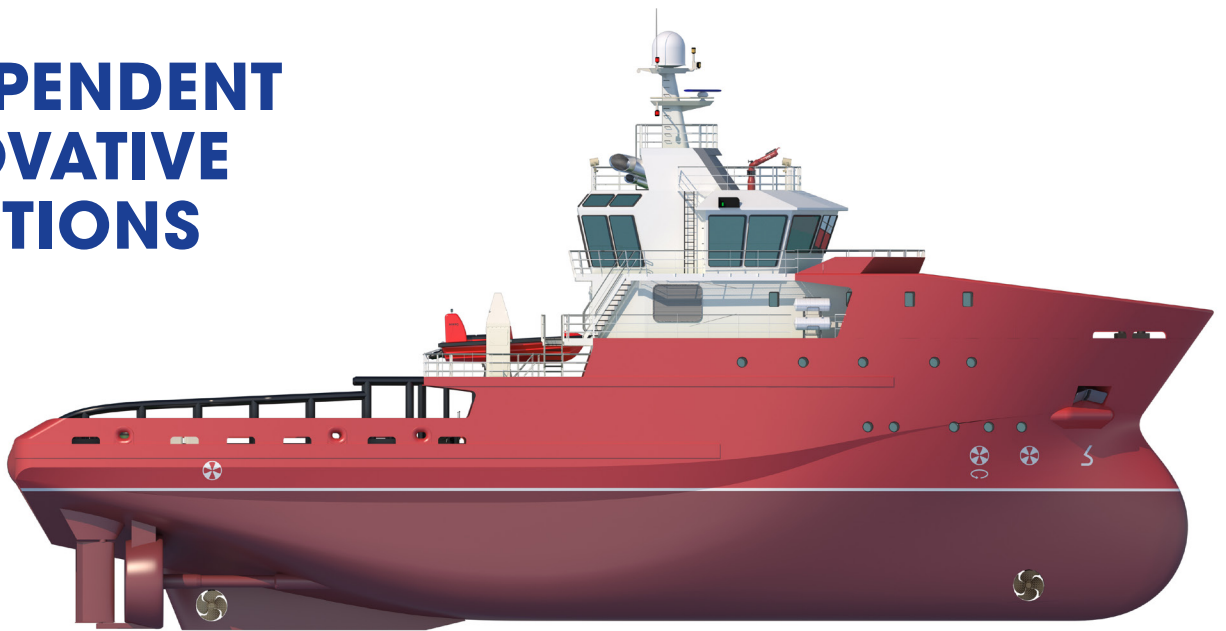

## OSD-IMT7501 AHT

### PRINCIPAL CHARACTERISTICS

Vessel type	Ocean Going AHT
LOA	51.20 m
Lpp	45.50 m
Breadth mld.	16.00 m
Depth main deck	7.50 m
Draft design	5.50 m
BP ahead	100-120 tonnes
Speed	14.5 – 15.5 knots

### MACHINERY

Main engines	2x	3000 – 3600 kW
Main propulsion	2x	CPP 3200 -3400 mm in high efficiency nozzle
Bow thruster	1x	450 kW (2nd bowthruster or retractable azimuthing bowthruster optional)
Stern Thruster	1x	450 kW (optional)
Generator sets	2x	600 ekW
Shaft generators	2x	1000 ekW (optional)
EM Generator set	1x	120 ekW
Towing Winch		hydraulic or electric, waterfall, 250 - 300 tonnes brake holding power
Spare wire reel		1000 m
Stern roller		3000 mm, 170 ton WL
Towing pins + Karm fork	150	tonnes SWL
Tugger winch	2x	10 tonnes
Store / deck crane		hydraulic foldable knuckle boom (optional)
FiFi-1, waterspray	2x	1400m³/hr (optional)

### ACCOMMODATION (AIR-CONDITIONED)

Accommodation	14	crew, MLC 2006 compliant
	6	passengers (optional)

### CAPACITIES

Fuel oil	597 m³ (approx. 24 days endurance at 80% MCR on main engines)
Fresh water	116 m³
Black Water	72 m³
Various tanks	lubrication oil, hydraulic oil, dirty oil, sludge, etc.

### RADIO & NAVIGATION

GMDSS equipment	Area A-1, A-2, A-3
EPIRB	1x
SART	1x
Radar	1x X-band, 1 x S-band
Chart plotter	electronic
Dynamic positioning control	DP 2 (optional)

### LSA & FFA EQUIPMENT

Life rafts	2x	20 person life raft
MOB	1x	6 persons, outboard driven

### CLASS

BUREAU VERITAS  
 I ✘ HULL, ✘ MACH, ANCHOR HANDLING VESSEL, TUG, FIRE FIGHTING I (optional)-WATERSPRAY (optional), ✘ AUT-UMS, UNRESTRICTED NAVIGATION, DYNAPOS AM/AT R (optional), INWATERSURVEY (optional)

Mentioned power ratings are subject to owner and design requirements following operational profile, choice of equipment, redundancy philosophies and class rules. All figures are preliminary and approximate. No rights can be exercised based on these figures whatsoever.

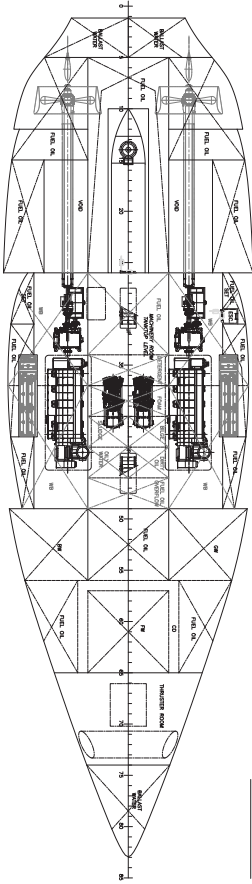

BELOW TANK TOP

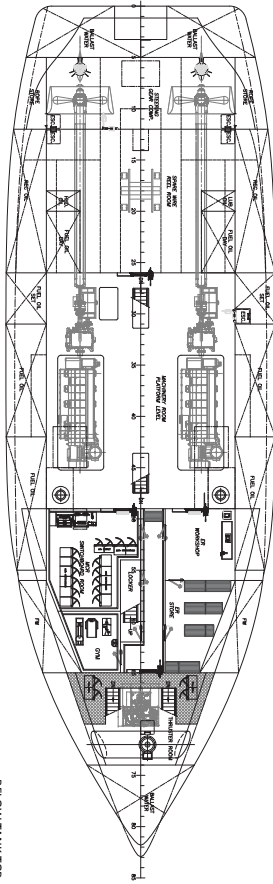

ABOVE TANK TOP

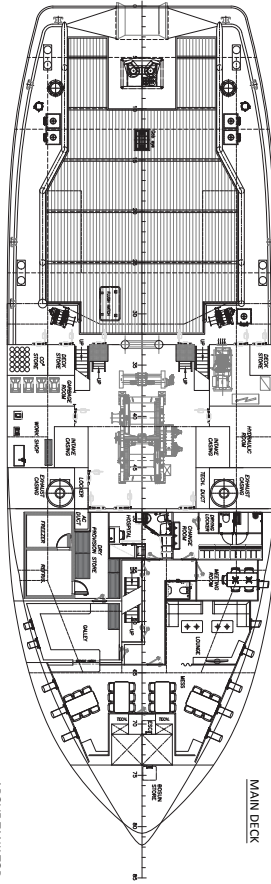

MAIN DECK

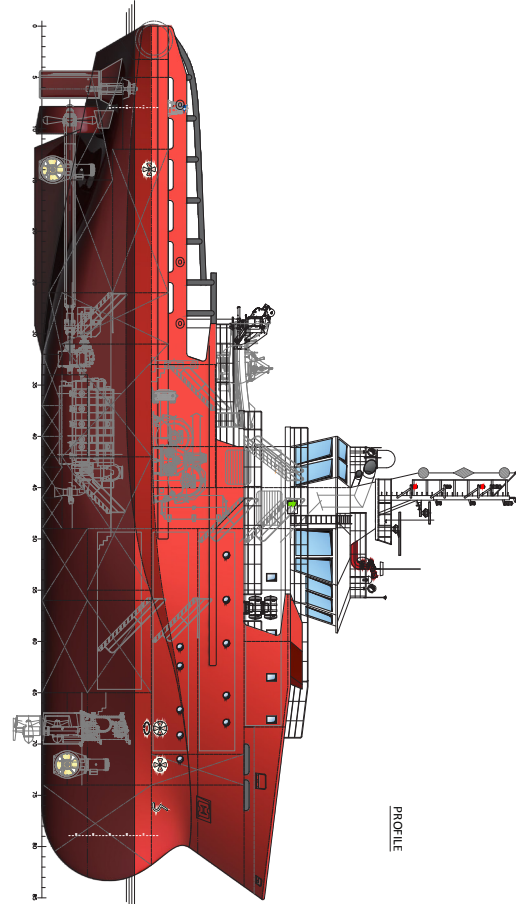

PROFILE

SHIP TYPE	AHT
SHIP NO.	7501
DESIGN NO.	7501
CLASSIFICATION	7501
DESIGNER	OSD-IMT
DATE	2023-08-20
SCALE	1:100
PROJECT NO.	7501
SHIP NO.	7501
DESIGN NO.	7501
CLASSIFICATION	7501
DESIGNER	OSD-IMT
DATE	2023-08-20
SCALE	1:100
PROJECT NO.	7501

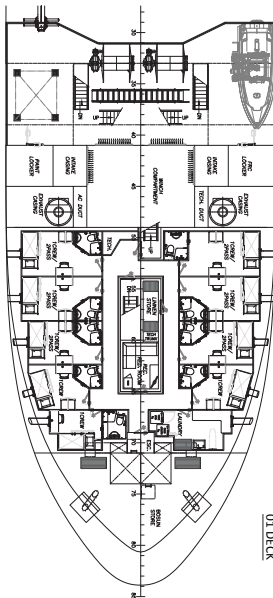

01 DECK

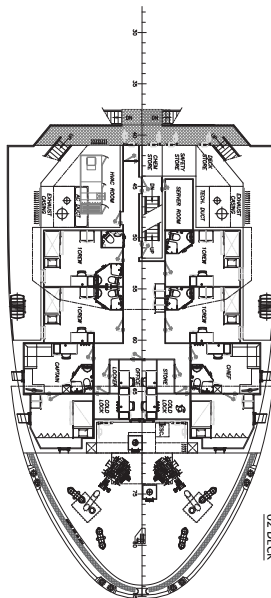

02 DECK

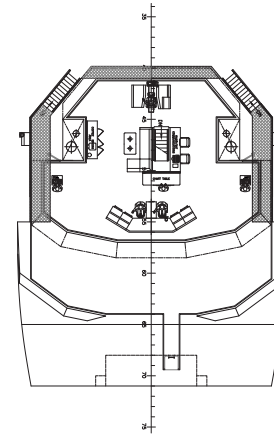

BRIDGE DECK

HEAD OFFICE HOOFDDORP

+31 255 545 070

info@osd-imt.com

UK OFFICES

+44 1382 317 120

info@osd-imt.com

SINGAPORE OFFICE

+65 6265 1154

info@osd-imt.com

**OSD IMT**

SHIP DESIGN & MARINE CONSULTANCY

OSD-IMT.com